

**ATISN 19154**

**Doc. 1. Email correspondence - Cadw and Flintshire CC local planning authority**

**From:** Cadw officer

**Sent:** Wednesday, March 29, 2023 5:50 PM

**To:** Flintshire CC

**Subject:** Registered park and garden - Shotton Steelworks Site

Hi [REDACTED],

I hope you are well. [REDACTED] has contacted us about the current situation at Shotton. I understand you intend to visit the site and I'd be grateful if you'd keep me in the loop on the situation with the registered park and garden please. If you wish to discuss please let me know.

Many thanks

 Cadw

**From:** Cadw officer

**Sent:** Tuesday, April 18, 2023 11:58 AM

**To:** Flintshire CC

**Cc:** Cadw officer

**Subject:** Shotton garden

Hi [REDACTED],

I just tried to call but it went to voicemail so following up with an email. We've just had a meeting here in Cadw about Shotton. There is considerable ministerial interest in the situation and we need to provide a response to ministers asap.

Please could you/Flintshire CC provide an update in writing (email is fine) with clarification of what has happened on site and what your recommendations are (including the temporary planning for the fence, TPOs, as we discussed yesterday). Could you please include whether Flintshire CC is in discussion with the owners, work undertaken by the owner so far, and what their intentions are for the site (if known).

I'm available on the mobile all day today if you'd like to discuss.

Many thanks

[REDACTED]

 Cadw

**From:** Cadw officer  
**Sent:** Thursday, April 20, 2023 9:45 AM  
**To:** Flintshire CC  
**Cc:** Cadw officer  
**Subject:** RE: Former John Summers Steelworks gardens  
**Importance:** High

Hi [REDACTED],

Thank you for this. We'd strongly support TPOs for surviving trees of the Colvin landscaping before the ongoing works remove them all. [REDACTED] sent me the attached photos yesterday. I think they were from [REDACTED] so hopefully you have also received them - as well as the tree removal, the site has been levelled and the low walls around the parking bays seem to have also now gone – would the walls be considered curtilage listed? Please could you ask if we can receive Flintshire's formal response this week, so we are in a position to advise Ministers.

I'm on the mobile all day today if you want to discuss.

Many thanks

[REDACTED]

**From:** Flintshire CC  
**Sent:** 19 April 2023 13:05  
**To:** Cadw officer  
**Subject:** FW: Former John Summers Steelworks gardens

Hi [REDACTED],

Sorry for not being able to take your call yesterday as I was on leave.

The formal car parking bays and walls were still in situ when I visited the site on the 29<sup>th</sup> March 2023. Here is an image I took showing the extent of the clearance works, which shows that the central tree avenue has been felled along with some trees around the perimeter. The most recent google earth image appears to show the car park obscured by vegetation although the central avenue and perimeter trees are clearly evident prior to the clearance work being undertaken.

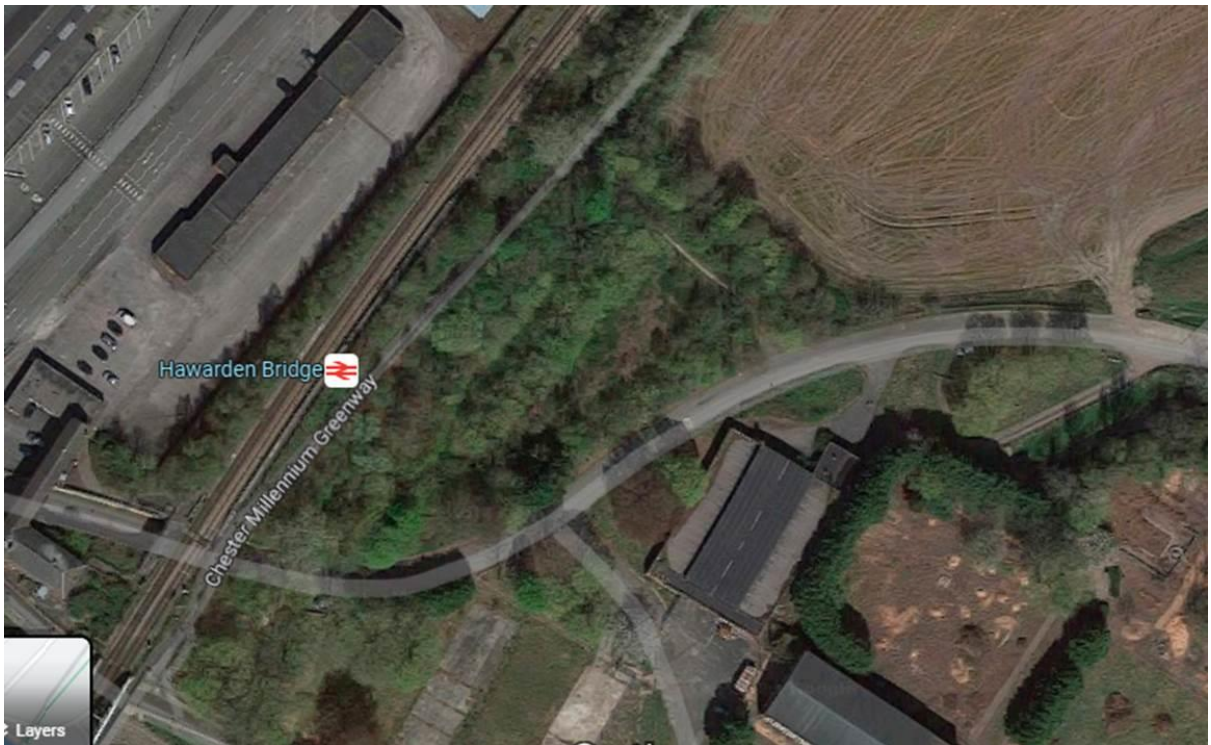

I understand that officers will be discussing the matter soon from which we will get a formal response to you outlining the authority's stance and what action that we could consider taking.

Regards,

██████████

████████████████████

(Cynllunio, Amgylchedd ac Economi) Flintshire County Council | Cyngor Sir y Fflint

**From:** Cadw officer  
**Sent:** 18 April 2023 09:50  
**To:** Flintshire CC  
**Subject:** Shotton gardens

...and here are the planting plans. The tree planting in the car park was of Norway maple, field maple, beech, birch and alder, and a holm oak.



**From:** Cadw officer  
**Sent:** Friday, April 21, 2023 9:11 AM  
**To:** Flintshire CC  
**Cc:** Flintshire CC; Cadw officers  
**Subject:** RE: outline of devastation

Hi All,

Thank you for your email yesterday. The only times I could do today are between 1.30-2.30 or after 3.30. The only powers we have with regards to the registered park and garden are as statutory consultees in the planning system. There is no consent process for registered parks and gardens, so for works that do not require planning consent all we can offer is our advice. Designations, such as TPOs, listing, and scheduling can protect individual elements of designed landscapes, and in this case considering TPOs for the surviving trees of the Colvin landscape. We have a copy of the original planting plan and can help with identifying trees of historic significance.

I have also written to ██████████ with our concerns about the damaging impacts of the work on the registered garden and have asked for them to engage with us before any further work is undertaken. We hope we can work together with yourselves and the owners but I have not heard back from them yet.

Following your site visit yesterday please could you provide us with Flintshire's response clarifying what has happened on site and what your recommendations are. Do we know what the owner's intentions for the site are? Cadw have been asked to provide a response to Ministers on the current situation.

I hope this provides you with enough information from our perspective but if a Teams meeting would still be helpful please let me know.

Kind regards



**From:** Flintshire CC  
**Sent:** 20 April 2023 14:30  
**To:** Cadw officer  
**Cc:** Flintshire CC  
**Subject:** FW: outline of devastation

Hi 

Further to the latest information you have sent through, I think it would be useful for colleagues here to meeting with you virtually to understand Cadw's perspective on this issue and the powers you have to intervene from the perspective of the Historic Park and Garden designation. We are not clear that the LPA has any powers top intervene as is set out for listed buildings in TAN24, as the TAN is silent on these designations.

We are carrying out a enforcement fact finding site visit this afternoon and have already advised the land owner to cease all works until we can determine what he is doing and what may need planning consent.

‘m not in tomorrow but it would be useful if you had time to liaise with other colleagues copied in tomorrow if you have time.

If you could respond back to all then colleagues could arrange a Teams with you tomorrow.

Thanks 

**From:** Flintshire CC  
**Sent:** 19 April 2023 18:24  
**To:** Flintshire CC  
**Subject:** FW: outline of devastation

**From:** Cadw officer  
**Sent:** 19 April 2023 14:20  
**To:** Flintshire CC; Cadw officer  
**Subject:** Fwd: outline of devastation

Hi [REDACTED]  
I'm not sure if she has also contacted you but I've received the below from [REDACTED]. More tree removal and the site to be tarmac surfaced - surely this would require planning? I'm out today but is there anything we can do?  
Many thanks  
[REDACTED]

[REDACTED]

---

**From:** [REDACTED] >  
**Sent:** Wednesday, April 19, 2023 12:15 pm  
**To:** Cadw officer  
**Subject:** outline of devastation

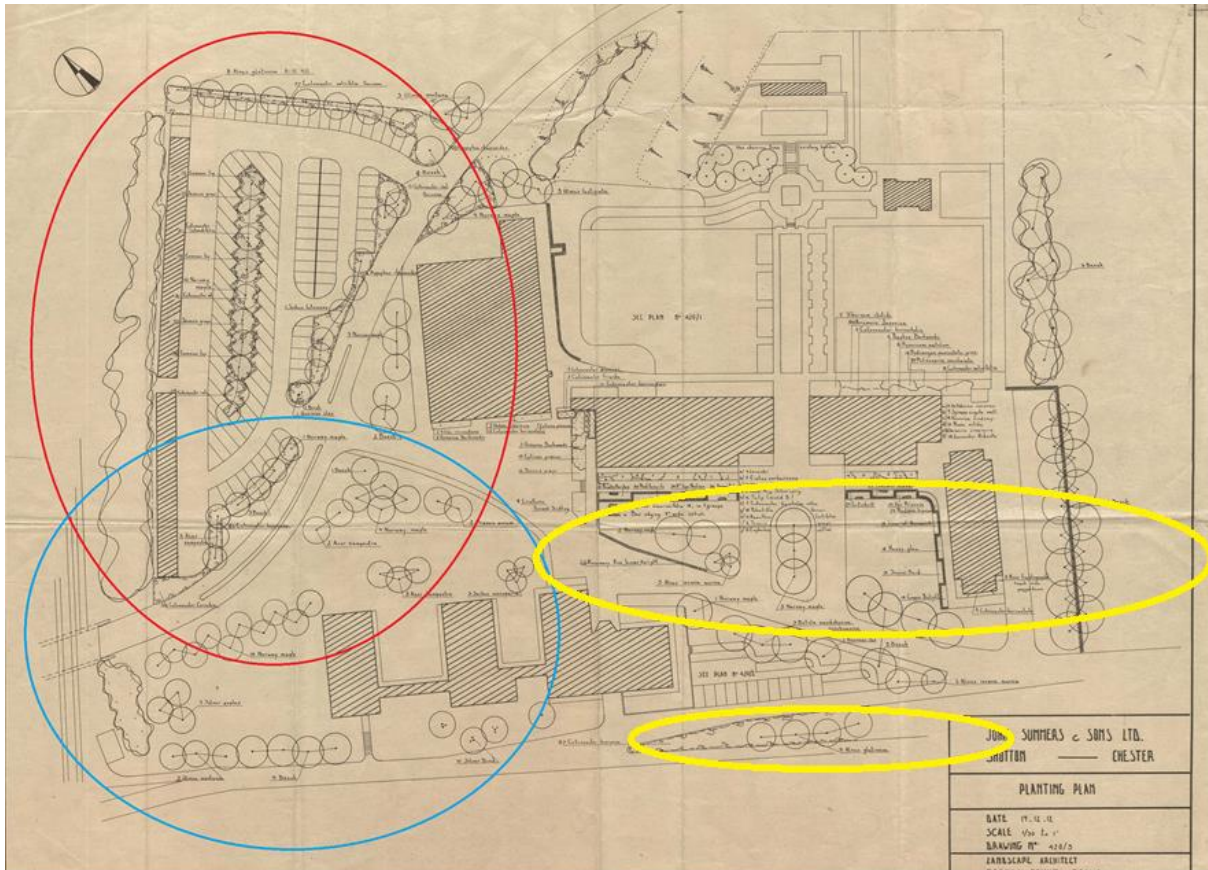

Hi [REDACTED],

[REDACTED] has just told me to contact you.

The 2 areas marked above have been decimated and every tree removed.

All the ones at the front of the buildings marked in yellow have been marked in blue ink for removal as well now so I guess they will be gone by the end of the week.

I found a dead little tawney owl on the ground this morning it is most distressing.

The ones cut down in the blue circle this week have been

copper beeches, weeping beech, Norway maple, field maple, Rowan tree, feathered Elm, wild cherry trees, with one planted for prince Charles

I have videos of the cleared land it is all being tarmacked today

[REDACTED]

**From:** Cadw officer

**Sent:** Monday, April 24, 2023 5:20 PM

**To:** Flintshire CC

**Cc:** Cadw officer

**Subject:** Shotton garden - update

**Importance:** High

Hello All,

We received an email this afternoon reporting further works being undertaken at the Shotton registered garden – reports of a bulldozer in the area of the sunken garden, which is very concerning.

If you have any further updates on the situation from the planning side and/or TPO designation for the surviving trees we would be grateful to receive it.

Kind regards

■



**From:** Flintshire CC

**Sent:** Wednesday, May 3, 2023 10:20 AM

**To:** Cadw officer

**Subject:** RE: EXTERNAL RE: Tree Preservation Order No.346(2023) at John Summers Garden

Dear ■,

Please find attached a copy of the TPO and associated documents.

Yours sincerely,

■

■

**From:** Cadw officer

**Sent:** 02 May 2023 08:43

**To:** Flintshire CC

**Cc:** Flintshire CC

**Subject:** EXTERNAL RE: Tree Preservation Order No.346(2023) at John Summers Garden



**CAUTION:** This email has reached Flintshire County Council from an external source. Please be extra cautious prior to opening any links or attachments, particularly if you weren't expecting the email or don't recognise the sender.

Hello [REDACTED],

Many thanks for letting me know. Please could you send us a copy of the TPO?

If you wish to discuss or have any questions about the registered historic park and garden, please do not hesitate to contact me.

Kind regards

[REDACTED]



[REDACTED]

**From:** Flintshire officer

**Sent:** 28 April 2023 15:55

**To:** Cadw officer

**Cc:** Flintshire officers

**Subject:** Tree Preservation Order No.346(2023) at John Summers Garden

Dear [REDACTED],

I am writing to advise you that the Council have made a provisional Tree Preservation Order (TPO) at the John Summers Garden, the boundary of which is coincident with the Historic Park and Garden at the site.

The TPO was made on 21 April and I can advise that the landowner and tenants have been subsequently served with copies. The provisional TPO will remain in force for a period of six months which will give the opportunity for it to be confirmed and made permanent.

Yours sincerely,

[REDACTED]

[REDACTED]

[REDACTED]

**From:** Cadw officer  
**Sent:** 26 April 2023 08:53  
**To:** Flintshire CC  
**Subject:** EXTERNAL Shotton registered garden  
**Importance:** High

**CAUTION:** This email has reached Flintshire County Council from an external source. Please be extra cautious prior to opening any links or attachments, particularly if you weren't expecting the email or don't recognise the sender.

Hello [REDACTED],  
I understand from [REDACTED] that you visited the Shotton site this week, which as you'll know is on the register of historic parks and gardens in Wales. Could you possibly update me on the current situation as soon as possible, either via email or I can give you a call today?

Many thanks

[REDACTED]



[REDACTED]

**From:** Cadw officer  
**Sent:** Thursday, May 25, 2023 12:11 PM  
**To:** Flintshire CC  
**Subject:** Tree Preservation Order consultation no 346

Dear [REDACTED]

We have been consulted on a notice for a Tree Preservation Order (TPO) at the grade II registered historic park and garden at Shotton Steelworks Garden PGW(C)76(FLT). The formal notice states that the Council has made the order because the land is a Cadw Registered Historic Park and Garden containing trees that were planted as part of the garden's design and which also complement the setting of the listed office buildings. The trees are publicly visible and as a result of the above designations it is deemed that they afford significant amenity to the area. Moreover, due to concerns about ongoing tree felling it is considered expedient to make the Tree Preservation Order with immediate effect on a provisional basis. The

TPO boundary corresponds with the boundary of the registered historic park and garden

Cadw has registered the site for the survival of the layout, formal structure and much of the major planting of a formal garden and forecourt designed by the distinguished landscape architect Brenda Colvin (1897-1981) to complement the adjacent office buildings. A particular aim of the garden was to provide recreational space for the office workers. A garden existed at Shotton before Colvin's involvement and was integrated into her design and further enhanced by Colvin. Colvin's landscaping plans for Shotton survive and are held at the Landscape Institute Archive at the Museum of English Rural Life (MERL), University of Reading.

We support a TPO for the registered garden to protect the remaining trees of historic significance. It is my view that the TPO should be in place to protect trees that are of historic significance to the registered historic park and garden, including trees planted as part of Colvin's designs as well as those incorporated into her plans and any of significance that may have been planted since. However, lack of ongoing management has allowed many self-seeded trees to grow across the site distorting the original planting scheme and design intention. Trees that have grown up as a result of neglect and lack of site management are not therefore considered to be of historic significance to the designed landscape. Cadw would be happy to help identify trees of significance to the registered historic park and garden to inform the TPO.

Kind regards.

 Cadw

[Redacted signature block]

**From:** Cadw officer  
**Sent:** Tuesday, May 2, 2023 7:06 PM  
**To:** Flintshire CC  
**Cc:** Cadw officers  
**Subject:** Shotton registered park and garden

Hi [Redacted]

Thank you for copying Cadw into your recent email to [Redacted]. The email refers to a written outline from the site owners for their long term strategy for the site. Cadw has not yet had sight of the owner's long term plans but going forward we ask to also be involved in discussions concerning the registered historic park and garden. Please let me know if a Teams meeting at this stage would be helpful.

Please do not hesitate to contact me if you wish to discuss,

Kind regards



**From:** Cadw officer

**Sent:** Tuesday, August 8, 2023 11:30 AM

**To:** Flintshire CC

**Subject:** FW: EXTERNAL Shotton Steel Works | draft masterplan

Hi All,

Thanks for sending over the plans from [REDACTED]. The extent of the masterplan covers all of the registered garden area, plus the adjacent land to the southeast.

Overall, the proposal to reinstate the registered gardens, including the bowling green and putting green, is positive but as I said last week, it's really important that we understand what remains of the original layout of the grounds (this includes the 1930s layout and the 1950s Colvin layout which enhanced the 1930s plan) before proposals are progressed any further. The first step would be for [REDACTED] heritage consultant to produce a Heritage Impact Assessment following Cadw's methodology [Heritage Impact Assessment | Cadw \(gov.wales\)](https://www.gov.wales/heritage-impact-assessment) to cover the whole site. This should also include an assessment of existing planting across the site, which may form part of the HIA or be provided as a separate report, but which identifies trees and shrubs of significance to the original planting scheme.

Do we have or can we ask for a record of significant trees that have been removed (ie. trees forming part of the original gardens rather than self-sown)?

The adjacent land is proposed for use as a car park, which I understand it has been used for previously. The masterplan shows the area will be somewhat screened by tree planting and the existing lab building. Further planting in the parking area would further soften the expanse of tarmac. The proposed building/viewing gallery proposed to the rear of the lab building seems unlikely to cause major concerns for the setting of the registered garden, but this would depend on its design.

The masterplan shows the northeast corner of the registered garden (the former tennis court) as a storage area surfaced with crushed hardcore. This area lies within the registered garden and I would advise that this area is not developed for storage or vehicle auction use and is instead reinstated as garden.

Between the 1950s buildings, the masterplan shows a possible central atrium and new lift access in this location. I flag this as of concern as it has the potential to interrupt the axial design and significant view along the central axis of the garden.

To the immediate west of the John Summers building, on the site of a former building, a car park compound post workshop is proposed. This element is likely to be quite intrusive and I advise that alternative options are considered. Earth mounding and tree planting as shown in the Colvin plans could help screen proposals in this area. I've attached extracts of the Colvin setting out plan.

The low brick walls seem to have been retained in the proposed public car parking area to the south of the forecourt, and around the perimeter of the former car park to the west of the entrance road (proposed car parking compound pre workshop). As we discussed last week, we would like to see the low brick walls that have been removed from the former car park to the west of the entrance road reinstated, along with the planting.

The wire mesh fencing/post and board fencing up to 2.5m high across the site is likely to be intrusive and will need careful consideration.

If you have any questions or wish to discuss any of the above please let me know,

Kind regards

■



■  
■  
■

**From:** Flintshire CC

**Sent:** Wednesday, August 2, 2023 10:34 AM

**To:**

■  
■  
■

**Cc:**

**Subject:** FW: EXTERNAL Shotton Steel Works | draft masterplan

Hi as discussed in this morning s meeting please find attached the plans provided by ■.

Yours faithfully

**CAUTION:** This email has reached Flintshire County Council from an external source. Please be extra cautious prior to opening any links or attachments, particularly if you weren't expecting the email or don't recognise the sender.

Afternoon Both,

Following our email correspondence [REDACTED] and our call [REDACTED] please see attached the following drawings:

- Site location plan
- Site block plan
- Site analysis plan
- Masterplan

We've looked at various options for the masterplan and have done a couple of iterations which is largely led by the unique nature of the new use of the site and how it will operate on a daily basis. We'd also really welcome some further understanding of the development surrounding the site and the changes to the road to the north as part of the Northern Gateway which is obviously outside the redline boundary but will impact the development.

As you can see, there are a lot of things going on and the detail is yet to be worked up, so this a high level exercise. We'd welcome feedback and are open to a meeting if that is easier. [REDACTED] – I'll take your lead on this in terms of if Cadw and the Historic Gardens Trust need to be part of this, but as discussed happy for you to pass this on to them.